

# Troy

## CYLINDER SURFACE FAMILY

### Wall Arm or Ceiling Mount

### Outdoor / Indoor Applications

We reserve the right to revise the design or components of any product without notice.

CATALOG #		TYPE
PROJECT/LOCATION		
APPROVED BY		

#### SPECIFICATIONS

- DRIVER — Universal Voltage (120~277V) with 0-10V dimming is standard. 347 Volt optional for White LED only.
- HOUSING — Heavy gauge aluminum cylinder.
- FINISH — Powder Coat Finish applied over pre-treated surfaces.
- LIGHT ENGINE — Energy Efficient LED Downlight (DN) is standard. For Wall Mount, LED Uplight (UP) is Optional.
- LENS — .156" Clear Tempered Glass (85) is Standard.
- MOUNTING — Surface or Wall Arm Mount.
- REFLECTOR — .032 Specular Aluminum Standard.
- COMPLIANCE — Built to comply with U.S. and Canadian Safety Standards. **Made in USA / Buy America Compliant / Buy American Act.** Ceiling surface and wall mount are suitable for Wet Locations.

Ceiling Mount (CM)



Wall Mount (WM)



#### ORDERING INFORMATION

Series	Size	Mounting	Wattage	CCT or Color	Voltage	Illumination	Finish	Options
ORDERING GUIDE:								

#### SERIES

TY = Troy Series

#### SIZE

- 10 = 10" Tall (7" dia.)
- 16 = 16½" Tall (7" dia.)
- 20 = 20" Tall (7" dia.)
- 26 = 26" Tall (7" dia.)

#### MOUNTING

- CM = Ceiling Mount
- WM = Wall Mount

#### DOWNLIGHT WATTAGE

- LED10 = 10W LED
- LED15 = 15W LED
- LED25 = 25W LED (20" and 26" CM Mount Only)

#### UPLIGHT WATTAGE (16"-26" WM Mount Only)

- LED10 = 10W LED
- LED15 = 15W LED

#### VOLTAGE

- 347 = 347 Volts (Consult Factory)
- UNV = Universal Voltage (120/277V) Driver

#### CONTROL SCENARIO

- 1U = Uplight Only
- 1D = Downlight Only
- 1UD = Uplight / Downlight - Single Control  
— Available for 16"-26" WM Only
- 2UD = Uplight / Downlight - Separate Control  
— Available for 16"-26" WM Only

#### STANDARD FINISH

- BK = Black
- BZ = Bronze
- PNA = Painted Natural Aluminum
- WH = White

#### PREMIUM UPCHARGE FINISH

- CC = Custom Color (Visit [www.ralcolor.com](http://www.ralcolor.com))  
— Provide RAL# or Make-to-Match Color Chip

#### MOUNTING ARM (WM Mount Only)

- ARM3 = 3" Length (10" & 16" Only)
- ARM6 = 6" Length (20" & 26" Only)

#### BEAM SPREAD OPTIONS

Note A: Not available with Static Color Inserts.

Note B: See Page 4 for Images/Examples

- S = Spot — 16°
- M = Medium — 28°
- W = Wide — 58°
- XW = X-Wide — 74°
- DL = Diffusion Lens  
— Includes Glare / Dust Control

#### DIMMING OPTIONS

MANUAL CONTROL (Wall Switch or Control System)

Note: 0-10V 100%-30% is Standard

- D7A = 0-10VDC LED Dimming Driver (100-10%)
- D7B = 0-10VDC LED Dimming Driver (100-1%)

#### BACKBOX OPTIONS<sup>2</sup>

Note: Required for EM Options.

- BBCM = Backbox Ceiling Mount 10.625" Sq. x 1.78"D<sup>4</sup>
- BBWM = Backbox Wall Mount 4.75"W x 8.75"H x 2.875"D

#### EMERGENCY BATTERY OPTIONS<sup>5</sup>

Meets California Energy Commission Title 20:  
(CEC-400-2014-009-CMF) Efficiency Standards

- EL4W = Integral LED 4 Watt <sup>2</sup> <sup>52</sup>
- EL8W = Integral LED 8 Watt <sup>2</sup> <sup>52</sup>

- REL4W = Remote LED 4 Watt
- REL8W = Remote LED 8 Watt
- REL16W = Remote LED 16 Watt

#### Cold Weather Emergency Batteries:

NON-CEC Compliant

- REL10W-CW = Remote LED 10 Watt - Cold Weather

#### NOTES:

- <sup>2</sup> Integral EL requires Backbox.
- <sup>4</sup> BBCM is also required for Surface Conduit applications.
- <sup>52</sup> Emergency Battery option will only illuminate the downlight portion of the fixture when active.
- <sup>55</sup> Final selection of the Battery Pack under discretion of Factory

#### CHOOSE ONE:

#### LED COLOR TEMPERATURE (CCT) or

- 3K = ±3000K range LED
- 35K = ±3500K range LED
- 4K = ±4000K range LED
- 5K = ±5000K range LED

#### STATIC COLOR (4K with Color Insert)

- ACI = Amber Color Insert
- BCI = Blue Color Insert
- GCI = Green Color Insert
- RCI = Red Color Insert

#### CM (CEILING MOUNT) AVAILABLE WATTAGES

SERIES / SIZE	UPLIGHT WATTAGES	DOWNLIGHT WATTAGES
TY-10-CM	N/A	10W / 15W
TY-16-CM	N/A	10W / 15W
TY-20-CM	N/A	10W / 15W / 25W
TY-26-CM	N/A	10W / 15W / 25W

#### WM (WALL MOUNT) AVAILABLE WATTAGES

SERIES / SIZE	UPLIGHT WATTAGES	DOWNLIGHT WATTAGES
TY-10-WM	N/A	10W / 15W
TY-16-WM	10W / 15W	10W / 15W
TY-20-WM	10W / 15W	10W / 15W
TY-26-WM	10W / 15W	10W / 15W

# Troy

## CYLINDER SURFACE FAMILY

### Wall Arm or Ceiling Mount

### Outdoor / Indoor Applications

We reserve the right to revise the design or components of any product without notice.

CATALOG #		TYPE
PROJECT/LOCATION		
APPROVED BY		

#### DIMENSIONS

##### CEILING MOUNT

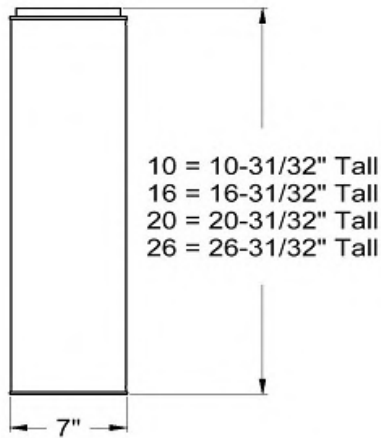

##### CEILING MOUNT w/ BBCM

For Integral EL or Surface Conduit Installations

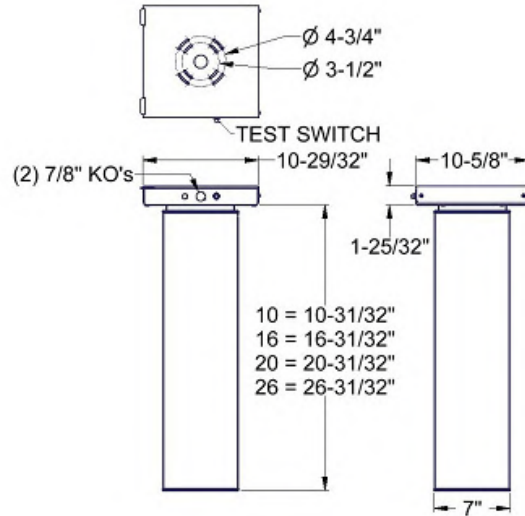

#### STANDARD WALL MOUNT (NON-EMERGENCY)

##### 10" Fixture

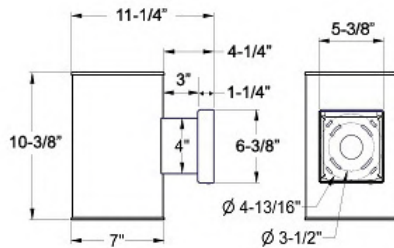

##### 16" Fixture

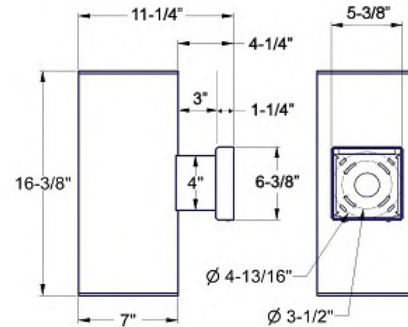

##### 20" Fixture

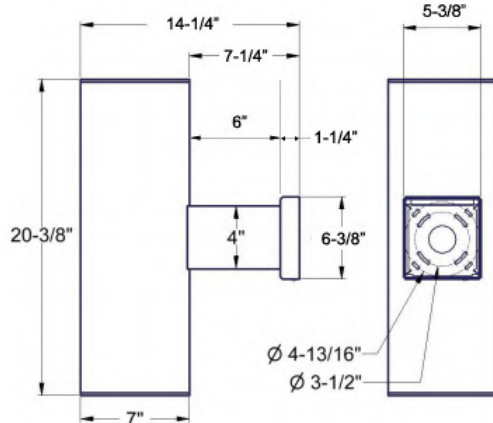

##### 26" Fixture

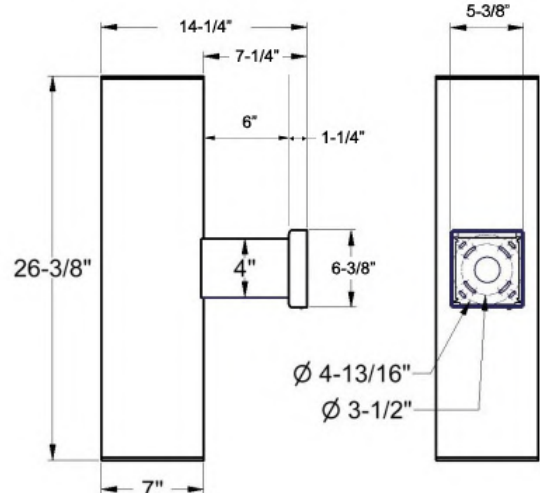

# Troy

## CYLINDER SURFACE FAMILY

### Wall Arm or Ceiling Mount

### Outdoor / Indoor Applications

We reserve the right to revise the design or components of any product without notice.

CATALOG #		TYPE
PROJECT/LOCATION		
APPROVED BY		

#### DIMENSIONS (cont.)

#### WALL MOUNT with BBWM (for applications that include Integral Emergency Battery)

10" Fixture

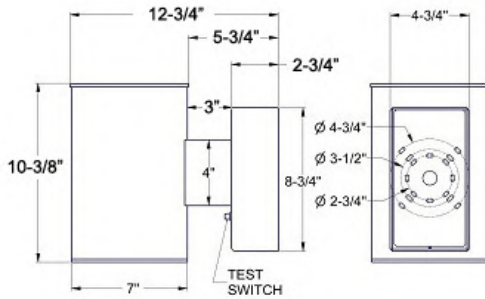

16" Fixture

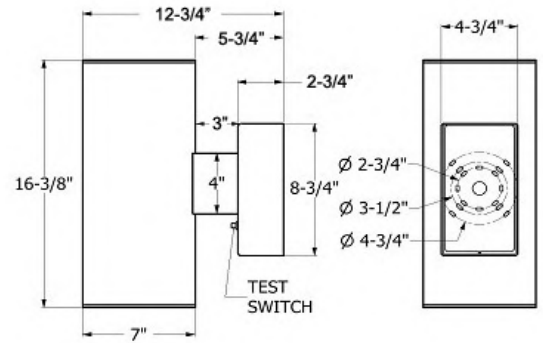

20" Fixture

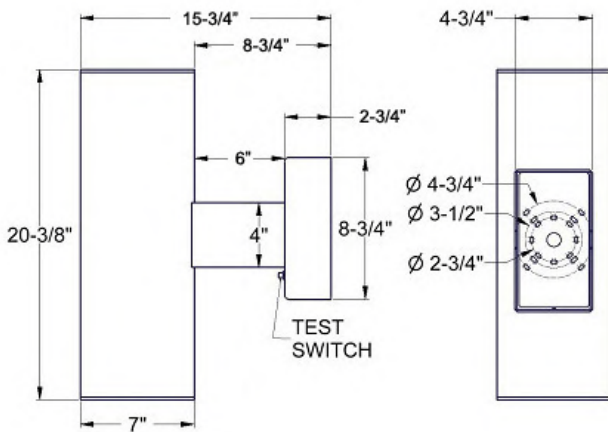

26" Fixture

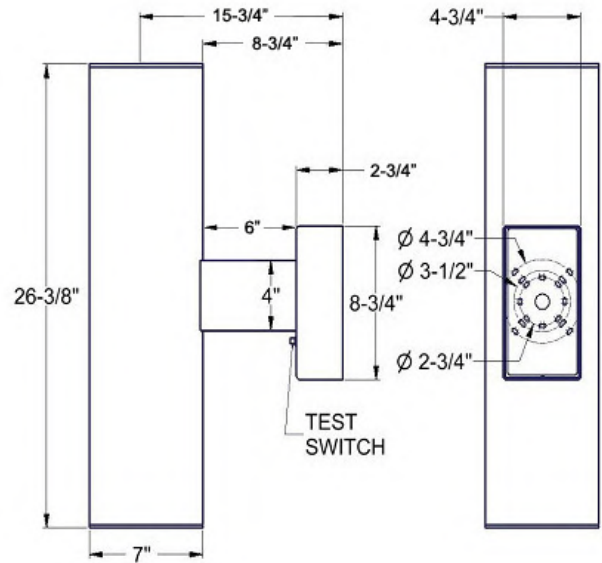

# Troy

## CYLINDER SURFACE FAMILY

Wall Arm or Ceiling Mount

Outdoor / Indoor Applications

We reserve the right to revise the design or components of any product without notice.

CATALOG #		TYPE
PROJECT/LOCATION		
APPROVED BY		

### OPTIONAL BEAM SPREADS

**NOTE:** Depiction of lumen distribution as depicted is subject to change minimally based upon selection of LED.

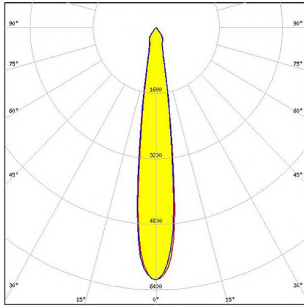

16° Spot (Wattage / Lumens)				
Watts	3000K	3500K	4000K	5000K
5W	649	693	702	711
10W	1491	1514	1533	1533
15W	2052	2084	2110	2136
25W	3229	3279	3321	3361

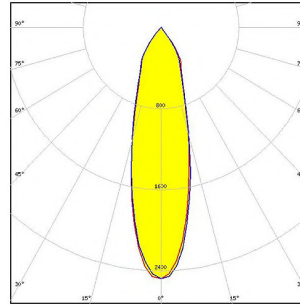

28° Medium (Wattage / Lumens)				
Watts	3000K	3500K	4000K	5000K
5W	649	693	702	711
10W	1491	1514	1533	1533
15W	2052	2084	2110	2136
25W	3229	3279	3321	3361

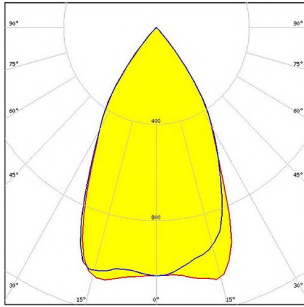

58° Wide (Wattage / Lumens)				
Watts	3000K	3500K	4000K	5000K
5W	642	686	694	703
10W	1475	1498	1517	1536
15W	2030	2061	2087	2113
25W	3195	3243	3285	3325

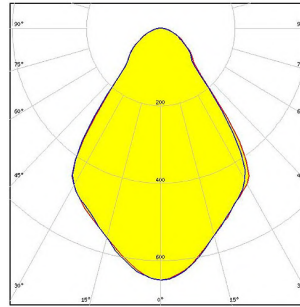

74° Extra Wide (Wattage / Lumens)				
Watts	3000K	3500K	4000K	5000K
5W	656	701	709	719
10W	1507	1531	1550	1570
15W	2074	2106	2132	2159
25W	3264	3314	3356	3398