

Biscayne Series

Area/Parking/Industrial

CFL, HID, LED, INDUCTION

Round Garage Luminaire — 3 Diameter Sizes

We reserve the right to revise the design or components of any product without notice.

CATALOG #		TYPE
PROJECT/LOCATION		
APPROVED BY		



SPECIFICATIONS

- BALLAST** — For Compact Fluorescent Electronic Cold Weather HPF is Standard. For HID Pulse Start is Standard. Optional High Temperature Electronic Ballast operates from -30°C up to 90°C max case temperature.
- DIFFUSER** — 12", 15" or 22" Diameter Acrylic with Clear Dome Lens, approximately 85% light to driving area and 15% uplight. IES Type 5 is Standard. Optional Polycarbonate.
- GASKETING** — High temperature, non-aging black EPDM and/or neoprene rubber concealed in Housing Pocket and Rear Wire Entrance Hole to protect against outside contaminants
- HOUSING** — Cast Aluminum. Finished in White Oven Baked Polyester Powder Coat
- LAMP** — (HID) Medium Base Metal Halide (Recommended use of lamps with UV Guard); (CFL) Compact Fluorescent, Induction QL - INCLUDED.
- LENS FASTENERS** — Stainless steel tamperproof screws (4) or Standard 8-32 to secure lens in place
- MOUNTING** — Direct Mount: Housing is supplied with (3) 5/16" Holes for 1/4" screws.
- SOCKET** — 4 KV rated medium base porcelain with 16 gauge 200° C – SF-2 lead wires
- UL/ULC Listed to U.S. and Canadian safety standards - Suitable for wet locations.

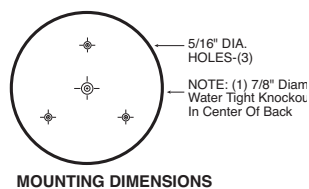
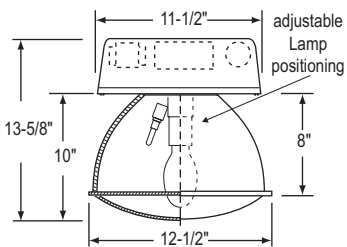

MOUNTING DIMENSIONS

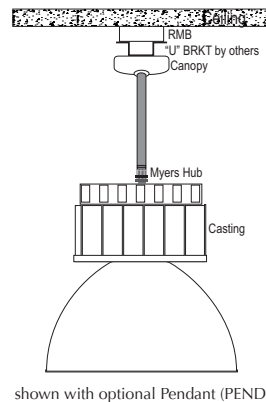
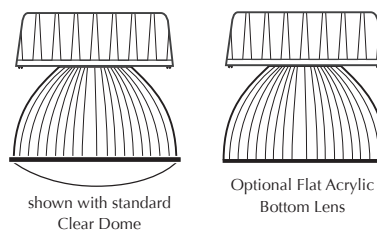

LAMP TYPE/QTY/WATTAGE ¹				
Fixture		BC	BCXL	BCXL1
Dimensions		12" dia. x 135/8"	15" dia. x 167/8"	22" dia. x 167/8"
Compact Fluorescent Triple Twin Tube	TTT	(1 or 2)42/57/70w	(3)57/70w	(1, 2, 3)57/70w
Metal Halide	MH	70/100/150w	200w	210w CMHE (277V Standard) Ceramic MH Philips - Elite™
Ceramic Metal Halide Philips - CosmoPolis™	CMHC	60, 90w (277V Standard) ¹	60, 90w (277V Standard) ¹	90/140w (277V Standard) ¹
QL Induction Up to 100,000 HR Lamp Life²	QL	85/165w	165w	165w
Light Emitting Diode	LED	50w	CONSULT FACTORY	

ORDERING GUIDE:

SERIES	LAMP TYPE/WATT	COLOR TEMP	VOLTAGE/POWER	FINISH	OPTIONS
--------	----------------	------------	---------------	--------	---------

NOTES:

- Consult Factory with requests regarding lamp sources, including LED, color temp., wattages or voltages not shown.
- Consult Factory for additional Emergency Battery options not shown.
- Lamping system is warranted by Osram and Philips for 40,000 HOURS.
- QRS: 120v Only—Lamp by Others
- Available with Step Dimming Option (CMHL) Philips-Lumistep™ Specify: "6" for 6hrs; "8" for 8hrs; "X" for 10hrs
- Not available w/ MH-200W

SERIES

- BC = Biscayne Series (12")
- BCXL = Biscayne Series (16")
- BCXL1 = Biscayne Series (22")

LAMP TYPE/QUANTITY/WATTAGE

Refer to Above Chart

COLOR TEMP (LED, Induction)

- 3K = ±3000K range Induction Only
- 4K = ±4000K range Induction Only
- 5K = ±5000K range LED or Induction

VOLTAGE

- 120 = 120 Volts
- 277 = 277 Volts
- 347 = 347 Volts
- 480 = 480 Volts (HID)
- EBU = Universal Voltage (120 thru 277v)
- QV = 120/208/240/277 Volts

POWER FACTOR

- EB = High Power Factor Electronic Ballast
- EBMH = Electronic Ballast for Metal Halide
- IND = HF Generator - INDUCTION

FINISH:

- BK = Black Finish
- BZ = Bronze Finish
- CC = Custom Color (consult factory) Finish
- WH = White Finish

EMERGENCY OPTIONS³

- RELS2 = Remote Emergency Battery Cold Weather (Bodine)
- TTT; 1-2 Lamp; up to 1250 Lms

OPTIONS

- CDR = Conical Dome Prismatic Lens
- CMHL = Ceramic Metal Halide CosmoPolis™ with Step Dimming: Lumistep™ (Philips)²
- FA = Flat Acrylic Bottom Lens^{2b}
- FUS = Single Fusing
- DFUS = Double Fusing
- HUB1 = 1/2" Myers Hub
- HUB2 = 3/4" Myers Hub
- ONB = Open Bottom
- PC = Prismatic Polycarbonate Diffuser
- PEND = Pendant Mount, 1/2" conduit entrance hole. Must Specify Stem Length
- QM = Quick Mount Bracket
- QRS = Quartz Restrike Relay⁵
- SDIM = QL165 Induction 50% Step Dimming
- RMB = Rapid Mount Galvanized "J" Box (BC Only)
- SG = 10KA Surge Protection for LED fixtures (meets ANSI spec C62.41.2)

PHOTOMETRIC DATA:

BISCAYNE Series

LSI test # 16091 BC-TTT-(3)42W-120-2EB-FA
 prismatic acrylic dome and clear sag lens
 Test Date: 02/18/02

Zunal Lumen Summary			
Zone	Lumens	%Lamp	%Luminaire
0-30	485	5.06	8.86
0-40	928	9.67	16.92
0-60	2227	23.21	40.60
0-90	3853	40.14	70.22
40-90	2924	30.47	53.30
60-90	1625	16.93	29.62
90-180	1633	17.02	29.78
0-180	5487	57.16	100.00

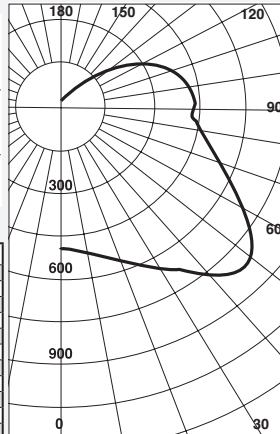
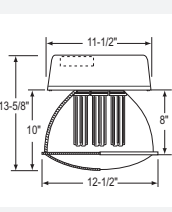

Efficiency: 57.3%

Coefficients of Utilization									
Room Cavity Ratio	PCC>	80%			70%			50%	
		70%	50%	30%	70%	50%	30%	50%	30%
PW>	0	64	64	64	61	61	61	54	54
1	1	56	53	50	53	50	47	44	42
2	2	50	45	40	47	42	38	37	34
3	3	45	39	33	42	36	32	32	28
4	4	41	34	28	38	32	27	28	24
5	5	37	29	24	35	28	23	25	20
6	6	34	26	21	32	24	19	22	18
7	7	31	23	18	29	22	17	19	15
8	8	29	20	15	27	19	15	17	13
9	9	26	18	13	25	17	13	15	11
10	10	24	17	12	23	16	11	14	10

Rm. Percentage = 20%; PCC = Ceiling Reflectance; PW = Wall Reflectance

LSI test #15460 BC-IND-165W-277-V-WH
 prismatic type 5 dome and lens
 Test Date: 05/08/01

Zunal Lumen Summary			
Zone	Lumens	%Lamp	%Luminaire
0-30	1910	15.92	14.02
0-40	3278	27.32	24.05
0-60	6266	52.22	45.97
0-90	9814	81.78	71.99
40-90	6535	54.46	47.94
60-90	3547	29.57	26.03
90-180	3817	31.81	28.01
0-180	13631	113.60	100.00

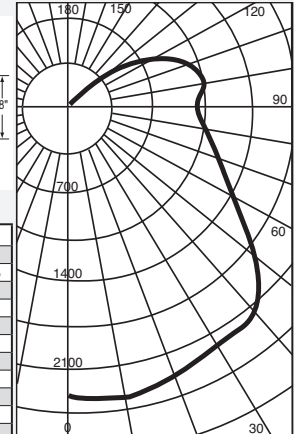
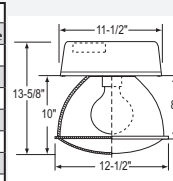

Efficiency: 113.7%

Coefficients of Utilization									
Room Cavity Ratio	PCC>	80%			70%			50%	
		70%	50%	30%	70%	50%	30%	50%	30%
PW>	0	128	128	128	121	121	121	109	109
1	1	113	107	101	107	101	96	90	86
2	2	102	92	84	96	87	79	78	72
3	3	93	80	70	87	76	67	68	61
4	4	85	71	61	80	67	58	60	53
5	5	78	63	52	73	60	50	54	46
6	6	71	56	46	67	53	44	48	40
7	7	65	50	40	62	47	38	43	35
8	8	60	45	35	57	43	34	39	31
9	9	56	41	31	53	39	30	35	27
10	10	52	37	28	49	35	27	32	25

Rm. Percentage = 20%; PCC = Ceiling Reflectance; PW = Wall Reflectance

LSI test # 50333 BC-MH-200W-PS-WH
 prismatic refractor and clear plastic drop lens
 Test Date: 09/11/00

Zunal Lumen Summary			
Zone	Lumens	%Lamp	%Luminaire
0-30	1419	7	8
0-40	2641	13	14
0-60	7631	36	41
0-90	15357	73	82
40-90	2677	13	14
60-90	3406	16	18
90-180	3470	17	18
0-180	18827	90	100

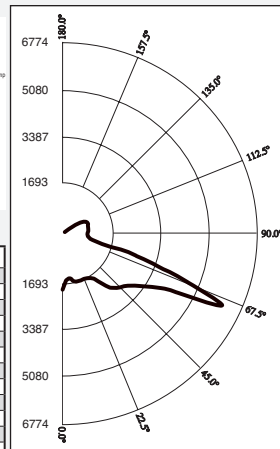
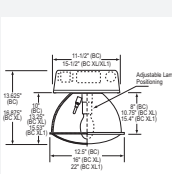

Efficiency: 89.7%

Coefficients of Utilization									
Room Cavity Ratio	PCC>	80%			70%			50%	
		70%	50%	30%	70%	50%	30%	50%	30%
PW>	0	105	105	105	101	101	101	92	92
1	1	93	87	82	88	83	79	76	72
2	2	81	72	64	77	69	62	63	57
3	3	72	60	51	68	58	49	52	45
4	4	64	51	42	61	49	40	44	37
5	5	58	44	35	55	42	33	38	30
6	6	53	39	29	50	37	28	33	26
7	7	48	34	25	46	33	24	30	22
8	8	45	31	22	42	29	21	27	19
9	9	41	28	19	39	27	19	24	17
10	10	39	25	17	36	24	17	22	15

Rm. Percentage = 20%; PCC = Ceiling Reflectance; PW = Wall Reflectance

LSI test # 16734 BCXL-TTT-(3)70W-120-2EB-DT
 prismatic acrylic dome and lens
 Test Date: 07/22/02

Zunal Lumen Summary			
Zone	Lumens	%Lamp	%Luminaire
0-30	1293	6.22	9.86
0-40	2553	12.28	19.46
0-60	5728	27.54	43.65
0-90	9672	46.50	73.71
40-90	7119	34.23	54.25
60-90	3944	18.97	30.06
90-180	3449	16.58	26.29
0-180	13122	63.09	100.00

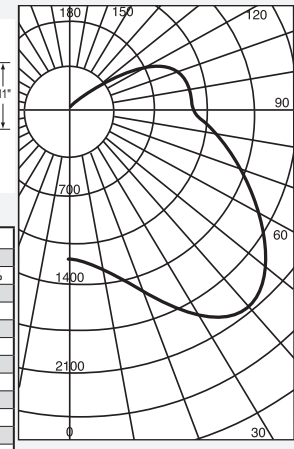
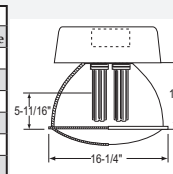

Efficiency: 63.2%

Coefficients of Utilization									
Room Cavity Ratio	PCC>	80%			70%			50%	
		70%	50%	30%	70%	50%	30%	50%	30%
PW>	0	71	71	71	68	68	68	61	61
1	1	63	59	55	59	56	53	50	48
2	2	56	50	45	53	47	43	42	39
3	3	50	43	37	47	41	36	37	32
4	4	46	38	32	43	36	30	32	27
5	5	42	33	27	39	31	26	28	23
6	6	38	29	23	36	28	22	25	20
7	7	35	26	20	33	24	19	22	17
8	8	32	23	17	30	22	17	20	15
9	9	29	21	15	28	20	15	18	13
10	10	27	19	13	26	18	13	16	12

Rm. Percentage = 20%; PCC = Ceiling Reflectance; PW = Wall Reflectance