

# Bollard Series

## AREA/PARKING/INDUSTRIAL

360° LOW-LEVEL LIGHTING  
ENERGY-SAVING "GREEN" LED



### SPECIFICATIONS

- **CERTIFICATIONS** — UL/ULC Listed to U.S. and Canadian safety standards. Complies to UL 1598 / CSA c22.2 No. 250-0-00. Wet Location Listed. LM79 Certified.
- **DRIVER** — Universal 120 thru 277 input voltage. Delivers 1400 milliamps of regulated Direct Current (DC) output to power LED Array.
- **ELECTRICAL** — Line Side, Three Pole Power Disconnects provided with Luminaire for simplified branch wiring. Optional Fusing available.
- **FINISH** — Fixture housing and domed top finished in Textured Bronze, oven baked polyester powder coat finish. Optional colors available.
- **GASKETING** — High Temp., NON-aging solid core silicone gasket rings seal lens to extruded housing and domed top, to protect against environmental contaminants.
- **HOUSING** — Extruded aluminum housing with flush mounting base and domed Top.
- **INTERNAL REFRACTOR** — IES Type V Clear Prismatic Borosilicate Glass Refractor.
- **LAMP** — 25 Watt, 4K White LED.
- **LENS FRAME FASTENERS** — Three Stainless Steel Hex set screws secure lens assembly to fixture housing.
- **MOUNTING** — Flush Mounting Base uses three 4" long concrete anchor bolts and positioning bracket included with luminaire. Optional: 8" (BAN8), 12" (BAN12) and 15" (BAN15) long anchor bolts available.
- **OUTER LENS** — Clear Cast Polycarbonate Outer Lens
- **POWER FACTOR** — LM79 Certified (95.5%)

We reserve the right to revise the design or components of any product without notice.

CATALOG #		TYPE
PROJECT/LOCATION		
APPROVED BY		

LED technology is advancing. Consult Factory or website for periodic updates as additional wattages with higher efficacy may be available.

**lighting facts<sup>CM</sup>**  
A Program of the U.S. DOE

Light Output (Lumens)	812
Watts	25.2
Lumens per Watt (Efficacy)	32

---

Color Accuracy Color Rendering Index (CRI)	81
---	----

---

**Light Color**  
Correlated Color Temperature (CCT) **4229 (Bright White)**

2700K 3000K 4500K 6500K

All results are according to IESNA LM-79-2008: Approved Method for the Electrical and Photometric Testing of Solid-State Lighting. The U.S. Department of Energy (DOE) verifies product test data and results.

Visit [www.lightingfacts.com](http://www.lightingfacts.com) for the Label Reference Guide.

Registration Number: 2R36-H687YV  
Model Number: BO-B-LED25H-EBU-WH  
Type: Bollard

LM80 tested chips from Nichia, Lumileds, Cree, Osram and Bridgelux are used in all Eclipse Lighting LED fixtures.

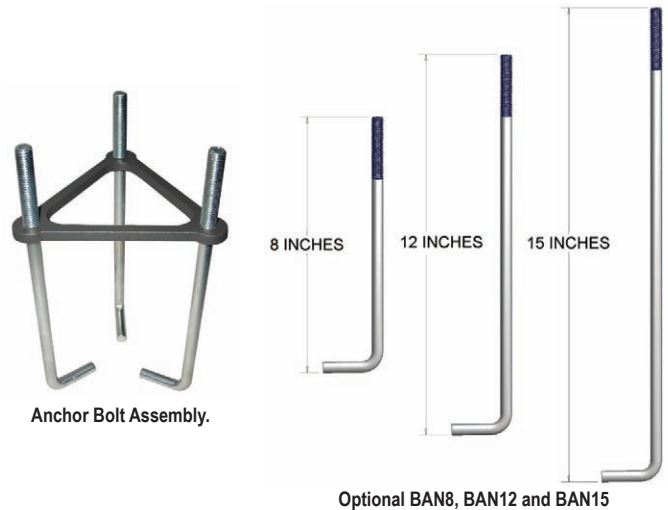

**ORDERING GUIDE:**

<b>SERIES</b>	<b>OPERATING WATTS</b>	<b>COLOR TEMP</b>	<b>VOLTAGE</b>	<b>FINISH</b>	<b>OPTIONS</b>
BO-R	25.2	4229K	EBU		

**BK** = Black Finish  
**BZ** = Bronze Finish  
**CC** = Custom Color Finish (Consult Factory)  
**WH** = White Finish

**BAN4** = Mounting Kit: Bracket, (3) 4" Anchor Bolts STANDARD  
**BAN8** = Mounting Kit: Bracket (3) 8" Anchor Bolts  
**BAN12** = Mounting Kit: Bracket (3) 12" Anchor Bolts  
**BAN15** = Mounting Kit: Bracket (3) 15" Anchor Bolts  
**FUS** = Single Fusing  
**SG** = 10KV Surge Protection (meets ANSI spec C62.41.2)

# PHOTOMETRIC DATA:

## Bollard Series Tested Using the IES LM79 Standards

ITL test # 26551 BL-BLED25H-EBU-WH  
with interior glass retractor  
and clear plastic cylinder lens

Test Date: 01/20/2010

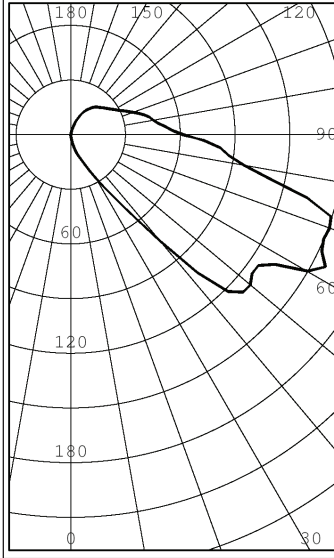

POWER FACTOR	95.5%
LUMENS (Light Output)	812
WATTS	25.2 (at test)
EFFICACY (Lumens per Watt)	32.2
CRI (Color Rendering Index)	81.2
CCT (Correlated Color Temp.)	4229K

		Coefficients of Utilization								
		90%			70%			50%		
Room Cavity Ratio	PCC>	70%	50%	30%	70%	50%	30%	50%	30%	
	0	119	119	119	108	108	108	98	98	
	1	103	95	88	92	86	80	77	72	
	2	90	78	67	80	69	61	62	55	
	3	79	64	52	70	57	47	51	42	
	4	71	55	42	62	49	39	43	34	
	5	64	46	35	55	41	31	36	27	
	6	58	40	29	50	35	25	31	22	
	7	52	35	24	45	31	21	27	18	
	8	47	30	20	42	27	18	24	16	
9	44	27	17	38	24	15	21	13		
10	40	25	14	35	21	13	19	11		

Rm. Percentage = 20%; PCC = Ceiling Reflectance;  
PW = Wall Reflectance

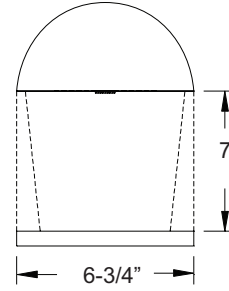

Zonal Lumen Summary		
Zone	Lumens	% Luminaire
0-30	11	1.41
0-40	41	5.09
0-60	247	30.45
0-90	622	76.67
40-90	581	71.58
60-90	375	46.22
90-180	189	23.33
0-180	812	100.00