

Bollard Series - Round

Area/Parking/Industrial

LED LAMPING

360° Low-Level Lighting

We reserve the right to revise the design or components of any product without notice.

CATALOG #		TYPE
PROJECT/LOCATION		
APPROVED BY		

SPECIFICATIONS

- HOUSING — Extruded Aluminum with Domed Top. Style B: Type 5 Clear Prismatic Borosilicate Glass; Style C: Aluminum Louver; Style D: Cone Reflector.
- FINISH — Nine-Stage Powder Coat Process. Bronze Finish (BZ) is Standard, Black (BK) or White (WH) Optional.
- LENS — Clear Polycarbonate
- DRIVER — Constant Current (700ma for 15W, 1400ma for 25W)
- LAMP — 15 or 25 Watt Super Bright-White LED.
- MOUNTING — Flush Mounting Base uses three 4" long concrete anchor bolts and positioning bracket included with luminaire. Optional: 8" (BAN8), 12" (BAN12) and 15" (BAN15) long anchor bolts available.
- UL/ULC Listed to U.S. and Canadian safety standards - Suitable for wet locations.



STYLE B: TYPE 5 GLASS



STYLE C: LOUVER



STYLE D: CONE REFLECTOR

ORDERING GUIDE:

SERIES	STYLE	SIZE	LAMP TYPE/QTY/WATT	COLOR TEMP	VOLTAGE/POWER	FINISH	OPTIONS
<input type="text"/>	<input type="text"/>	<input type="text"/>	<input type="text"/>	<input type="text"/>	<input type="text"/>	<input type="text"/>	<input type="text"/>

NOTES:

1 Consult Factory with requests regarding lamp sources, including LED, color temp., wattages or voltages not shown.

45 Visit our website for spec sheet featuring Lighting Facts Certified Model

SERIES

BO-R = Round Bollard SERIES 45

STYLE

B = Style B: Type 5 Glass
C = Style C: Louver
D = Style D: Cone Reflector

SIZE

M = 7" dia x 31" Tall
L = 7" dia x 43-3/8" Tall

LAMP TYPE/WATTAGE

LED15 = 15 Watt LED Board
LED25 = 25 Watt LED Board

LED COLOR TEMP

3K = ±3000K range
5K = ±5000K range

PRIMARY VOLTAGE

EBU = Universal Volt (120~277V)

FINISH

BK = Black Finish
BZ = Bronze Finish - Standard
CC = Custom Color Finish (Consult Factory)
WH = White Finish

OPTIONS

BAN8 = Mounting Kit: Bracket, (3) 8" Anchor Bolts
BAN12 = Mounting Kit: Bracket, (3) 12" Anchor Bolts
BAN15 = Mounting Kit: Bracket, (3) 15" Anchor Bolts
BL = Dual Circuit for High/Low Light Level
SG = 10KA Surge Protection for LED fixtures (meets ANSI spec C62.41.2)

PHOTOMETRIC DATA:

Bollard Series

Tested Using the IES LM79 Standards

ITL test # 26551 BL-BLED25H-EBU-WH
with interior glass retractor
and clear plastic cylinder lens

Test Date: 01/20/2010

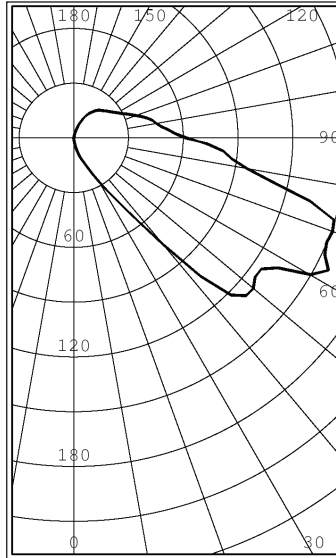

POWER FACTOR	95.5%
LUMENS (Light Output)	812
WATTS	25.2 (at test)
EFFICACY (Lumens per Watt)	32.2
CRI (Color Rendering Index)	81.2
CCT (Correlated Color Temp.)	4229K

		Coefficients of Utilization							
		90%		70%		50%			
Room Cavity Ratio	PCC>	70%	50%	30%	70%	50%	30%	50%	30%
	0	119	119	119	108	108	108	98	98
	1	103	95	88	92	86	80	77	72
	2	90	78	67	80	69	61	62	55
	3	79	64	52	70	57	47	51	42
	4	71	55	42	62	49	39	43	34
	5	64	46	35	55	41	31	36	27
	6	58	40	29	50	35	25	31	22
	7	52	35	24	45	31	21	27	18
	8	47	30	20	42	27	18	24	16
	9	44	27	17	38	24	15	21	13
10	40	25	14	35	21	13	19	11	

Rm. Percentage = 20%; PCC = Ceiling Reflectance;
PW = Wall Reflectance

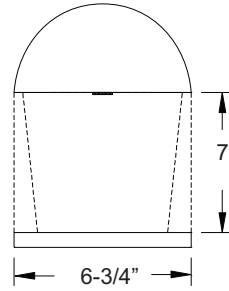

Zonal Lumen Summary		
Zone	Lumens	% Luminaire
0-30	11	1.41
0-40	41	5.09
0-60	247	30.45
0-90	622	76.67
40-90	581	71.58
60-90	375	46.22
90-180	189	23.33
0-180	812	100.00



Anchor Bolt Assembly.

8 INCHES

12 INCHES

15 INCHES

Optional BAN8, BAN12 and BAN15